

#### Overview

G2LED Lighting with patented ActiveLED technology provides an energy-efficient alternative to conventional high wattage parking lot lights without sacrificing light output. By incorporating ActiveLED's technology, the Shoe Box Parking Lot Light achieves energy savings of 50-85 percent over conventional lighting sources. The intelligent controller and options enable advanced energy management capabilities, thereby providing additional savings. The 90,000-hour LED lumen life is superior to any other light available today. Imagine a light lasting for 20 years when used an average of 12 hours a day.

#### Technical Specifications

|                    |  |
|--------------------|--|
| Dimensions         | 18"(L) x 14"(W) x 7"(H)<br>(45.7 x 35.6 x 17.8 cm)   |
| Mounting           | Square or round pole mounted   |
| Light Output       | 5280 LED Device Lumens   |
| Fixture Watts      | 52 watts   |
| Efficacy           | 110 LED Device Lumens/Watt   |
| CCT                | 5000K  |
| Power Factor       | >.95   |
| Input Voltage      | 100-277V AC  |
| Lumen Lifetime     | 90,000 hours<br>(95% Luminous Flux)  |
| Weight             | 24.2 lbs. (11.0 Kg)  |
| Listings and Tests | UL and CE listed, suitable for damp locations. RoHS compliant, LM-79 and LM-80 info available, IP66 rated. |

#### Key Features & Benefits

- Significant Energy Savings  
:: Replaces up to 400 watt fixture with 52 watt fixture
- Ideal lighting for parking lots, walkways and other outdoor applications
- Replaces yellow or dim lighting with more visible "white light" for uniformity of coverage and enhancing security
- LEDs do not emit ultraviolet light so bugs are not attracted to the ActiveLED fixture
- Full cut-off directional light (dark-sky compliant)
- Lower heat emission with small infrared footprint
- Environmentally safe lighting
  - Zero mercury content
  - Eliminates disposal of hazardous material
  - Facilitates LEED credits
- Options
  - Motion Sensor
  - Dusk-to-Dawn Sensor
  - Digital Dimmer
  - Battery Backup
  - Finish: Silver, Charcoal Grey and Brown, custom colors also available
- Warranty  
:: 10 years on LED elements, 5 years on materials and workmanship
- Made in the USA  
:: Designed and manufactured exclusively by Ringdale

# ActiveLED™ SL Series

## "Shoe Box" Parking Lot Light

### Pole Mount Diagram

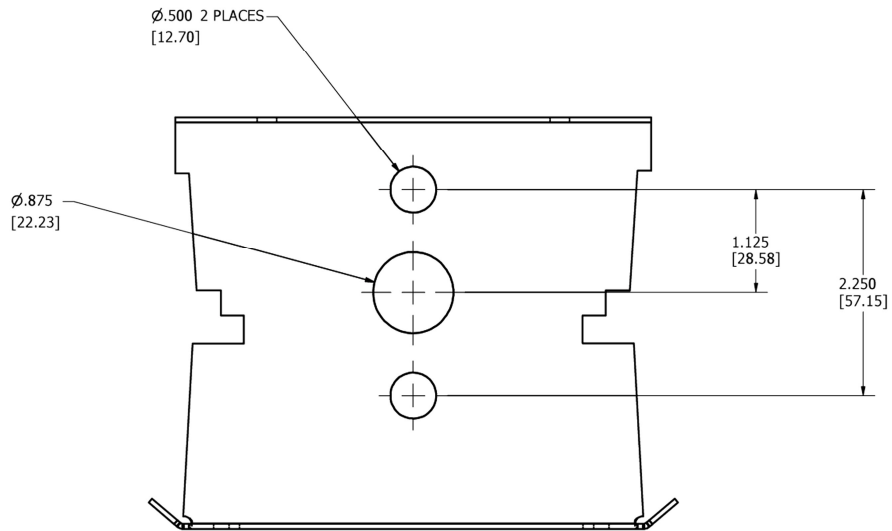

**INFORMATION | SALES | PRICING**

Cabella Systems, Inc.

47025 WCR 26 1/2 , Wiggins, Colorado 80654

DIRECT: 970.506.0525 | FAX: 970.373.4552

[www.g2led.com](http://www.g2led.com) | Email: [sales@g2led.com](mailto:sales@g2led.com)

